



The Explorer Hotel

Conferences, Meetings and Events



EXPLORERHOTEL.CA | YELLOWKNIFE, NT | 867.873.3531



Contents

03

Facility

04

Conference Services

05

Hotel Layout

06

Meeting Rooms

17

Capacity Chart Summary

19

Audio Visual

21

Partnerships & Photo Gallery

24

Contact Us

FLEXIBLE SPACES

We have the largest selection of flexible conference space in the North with 5 meeting rooms that may be used individually or combined to accommodate 10 to 500+



Our Facility

You'll like the meeting space we have to offer. We have plenty of it - a total of 7,500 sq ft. In fact, we are the largest convention center North of 60 equipped with the latest technologies, innovative catering menus and dedicated Event Manager on hand to ensure your event is a success.

Conference, Meeting and Event Services

- Natural light in pre-function areas
- Large windows with natural light in the Katimavik D and Katimavik E
- Wireless connectivity throughout
- Dedicated Event Manager for each event
- Clustered location of meeting rooms to facilitate breakout and parallel meetings
- Complimentary parking
- Tailor made menus to meet specific needs of every meeting
- Starbucks coffee included
- On-site audiovisual



Main Floor Layout

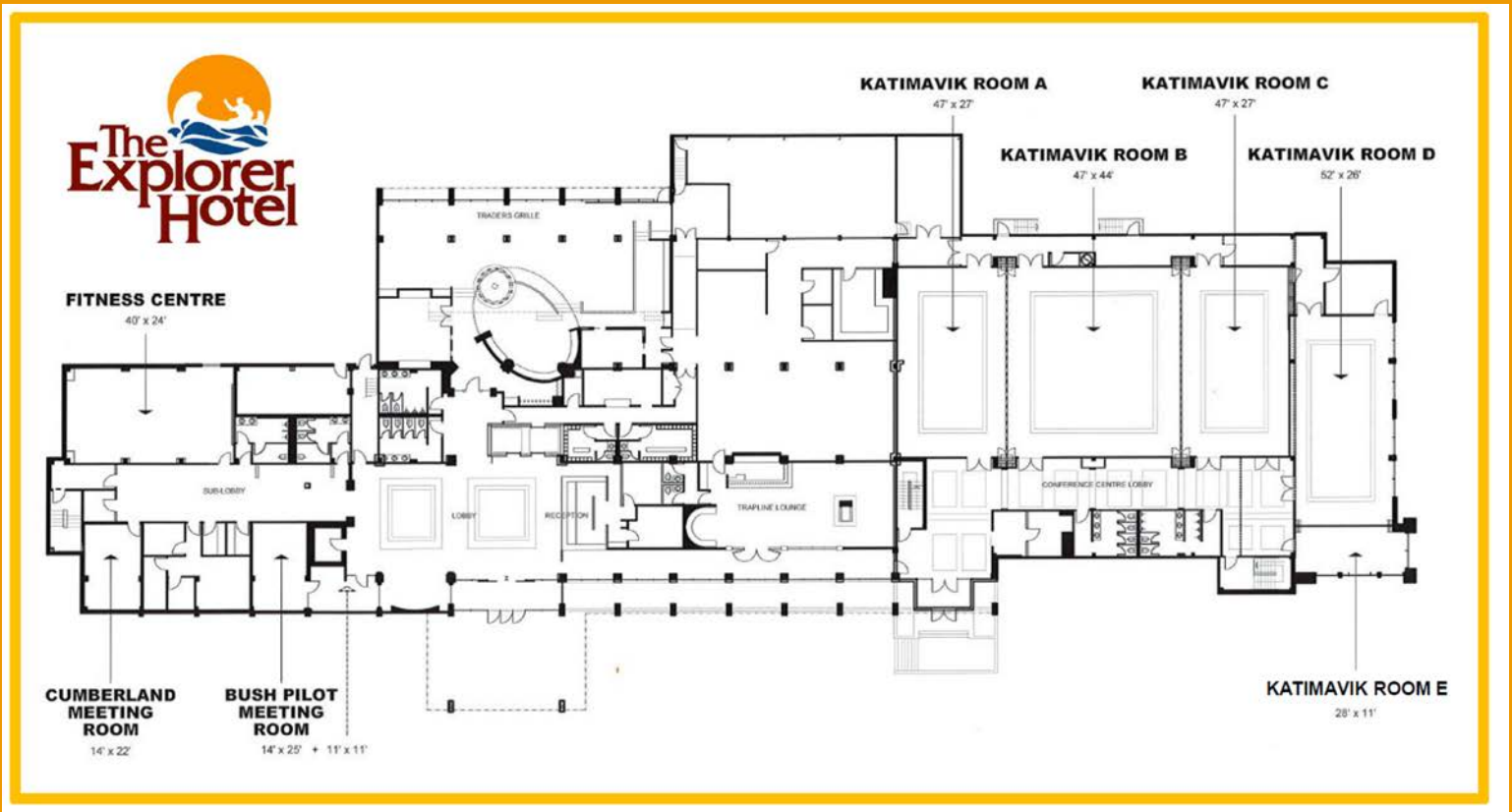

BUSH PILOT

Dimensions	Sq. Ft. Area	Banquet	Boardroom	Classroom	U-Shape	Hollow	Theatre
14'x22'	288	-	14	-	-	-	-



CUMBERLAND

Dimensions	Sq. Ft. Area	Banquet	Boardroom	Classroom	U-Shape	Hollow	Theatre
14'x21'	300	-	14	-	-	-	-

**GRAND
KATIMAVIK
A, B, C, & D**

Dimensions	Sq. Ft. Area	Banquet	Boardroom	Classroom	U-Shape	Hollow	Theatre
98'x47' 25'x52'(D)	6,258	300-380	192	306	160	192	546





GRAND KATIMAVIK
A, B, C, & D



KATIMAVIK A

Dimensions	Sq. Ft. Area	Banquet	Boardroom	Classroom	U-Shape	Hollow	Theatre
47'x27'	1269	60-80	40	60	32	40	108

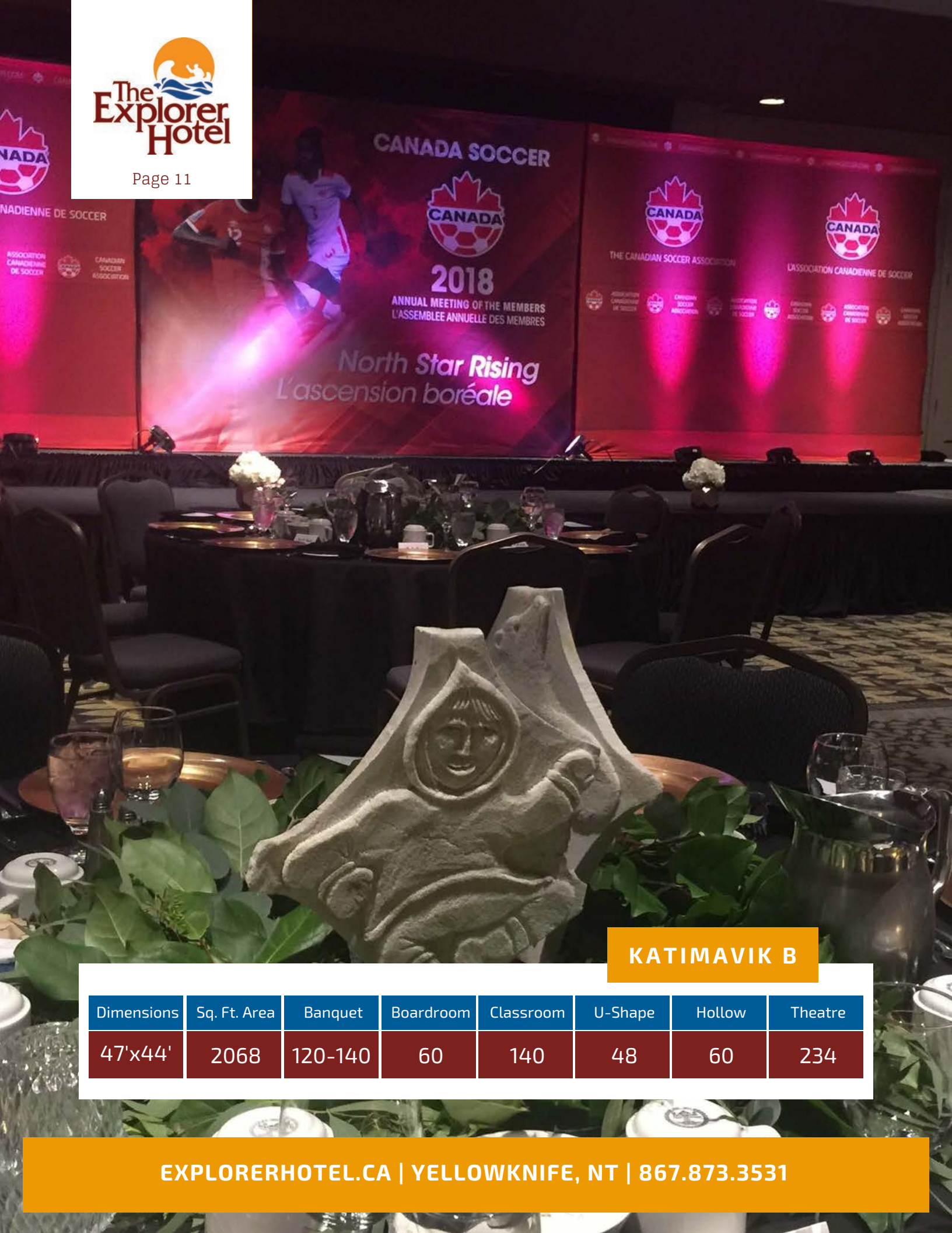

KATIMAVIK B

Dimensions	Sq. Ft. Area	Banquet	Boardroom	Classroom	U-Shape	Hollow	Theatre
47'x44'	2068	120-140	60	140	48	60	234

KATIMAVIK C

Dimensions	Sq. Ft. Area	Banquet	Boardroom	Classroom	U-Shape	Hollow	Theatre
47'x27'	1269	60-80	40	60	32	40	108

KATIMAVIK D

Dimensions	Sq. Ft. Area	Banquet	Boardroom	Classroom	U-Shape	Hollow	Theatre
25'x52'	1302	60-80	52	46	48	52	96

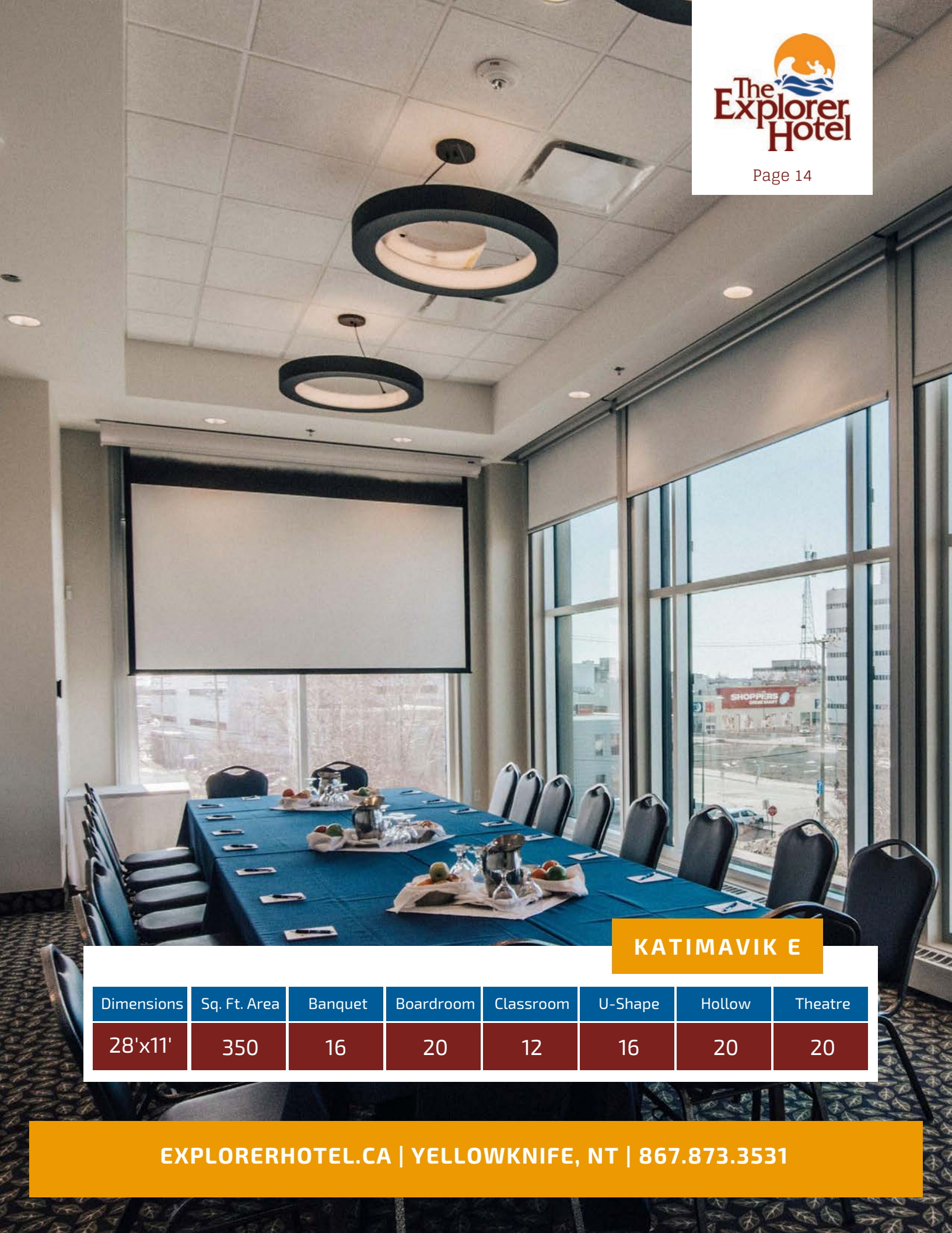

KATIMAVIK E

Dimensions	Sq. Ft. Area	Banquet	Boardroom	Classroom	U-Shape	Hollow	Theatre
28'x11'	350	16	20	12	16	20	20

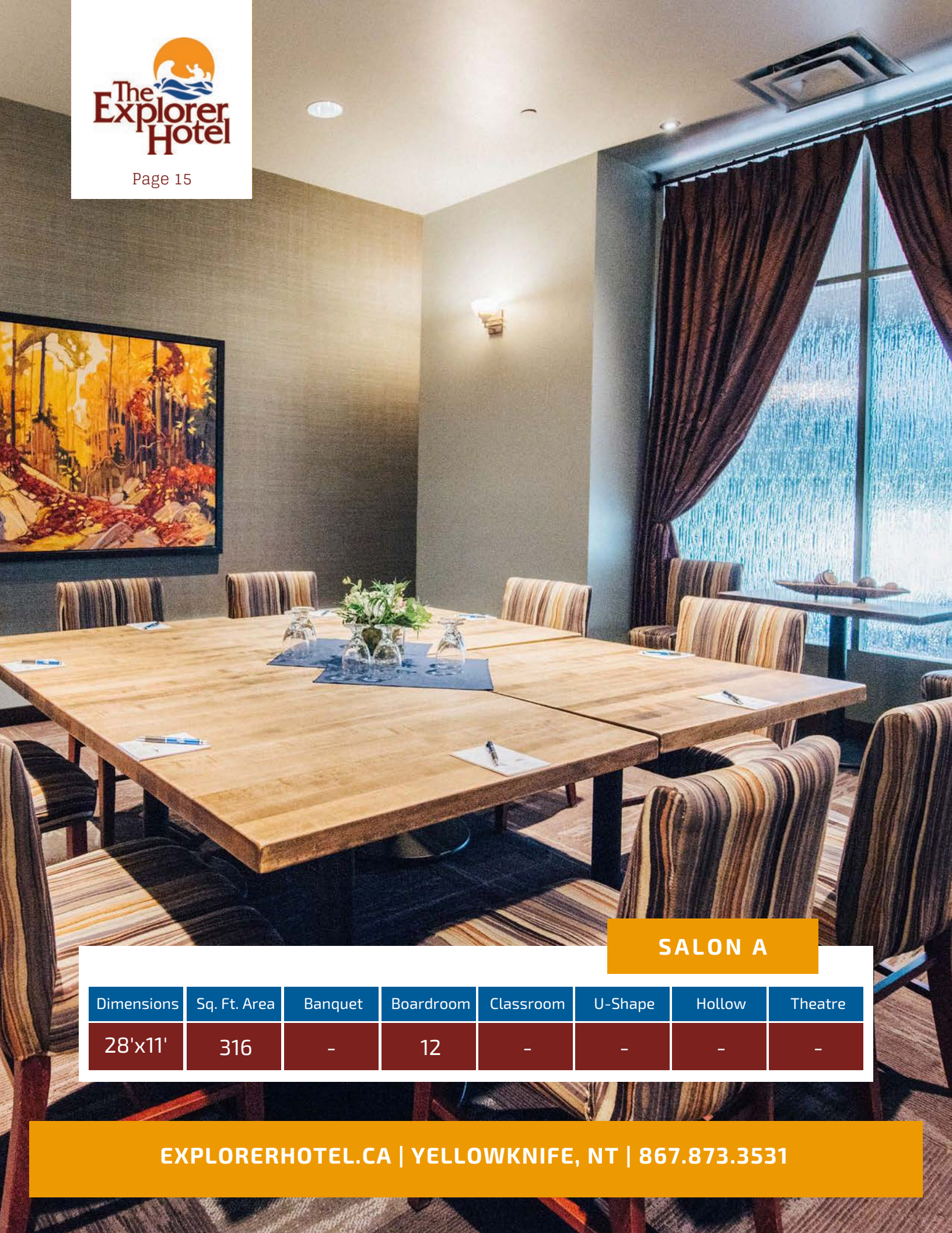

SALON A

Dimensions	Sq. Ft. Area	Banquet	Boardroom	Classroom	U-Shape	Hollow	Theatre
28'x11'	316	-	12	-	-	-	-



SALON B

Dimensions	Sq. Ft. Area	Banquet	Boardroom	Classroom	U-Shape	Hollow	Theatre
18'x22'	391	20	-	-	-	14	-

CAPACITY CHART SUMMARY

GRAND KATIMAVIK BALLROOM - A, B, C, & D

Dimensions	Sq. Ft. Area	Banquet	Boardroom	Classroom	U-Shape	Hollow	Theatre
98'x47' 25'x52'(D)	6,258	300-380	192	306	160	192	546

KATIMAVIK A

Dimensions	Sq. Ft. Area	Banquet	Boardroom	Classroom	U-Shape	Hollow	Theatre
47'x27'	1269	60-80	40	60	32	40	108

KATIMAVIK B

Dimensions	Sq. Ft. Area	Banquet	Boardroom	Classroom	U-Shape	Hollow	Theatre
47'x44'	2068	120-140	60	140	48	60	234

KATIMAVIK C

Dimensions	Sq. Ft. Area	Banquet	Boardroom	Classroom	U-Shape	Hollow	Theatre
47'x27'	1269	60-80	40	60	32	40	108

KATIMAVIK D

Dimensions	Sq. Ft. Area	Banquet	Boardroom	Classroom	U-Shape	Hollow	Theatre
25'x52'	1302	60-80	52	46	48	52	96

KATIMAVIK E

Dimensions	Sq. Ft. Area	Banquet	Boardroom	Classroom	U-Shape	Hollow	Theatre
28'x11'	350	16	20	12	16	20	20

CAPACITY CHART SUMMARY

BUSH PILOT

Dimensions	Sq. Ft. Area	Banquet	Boardroom	Classroom	U-Shape	Hollow	Theatre
14'x22'	288	-	14	-	-	-	-

CUMBERLAND

Dimensions	Sq. Ft. Area	Banquet	Boardroom	Classroom	U-Shape	Hollow	Theatre
14'x21'	300	-	14	-	-	-	-

SALON A

Dimensions	Sq. Ft. Area	Banquet	Boardroom	Classroom	U-Shape	Hollow	Theatre
28'x11'	316	-	12	-	-	-	-

SALON B

Dimensions	Sq. Ft. Area	Banquet	Boardroom	Classroom	U-Shape	Hollow	Theatre
18'x22'	391	20	-	-	-	14	-

**A GRAND TOTAL OF
7,500 SQ FT
OF
MEETING SPACE**

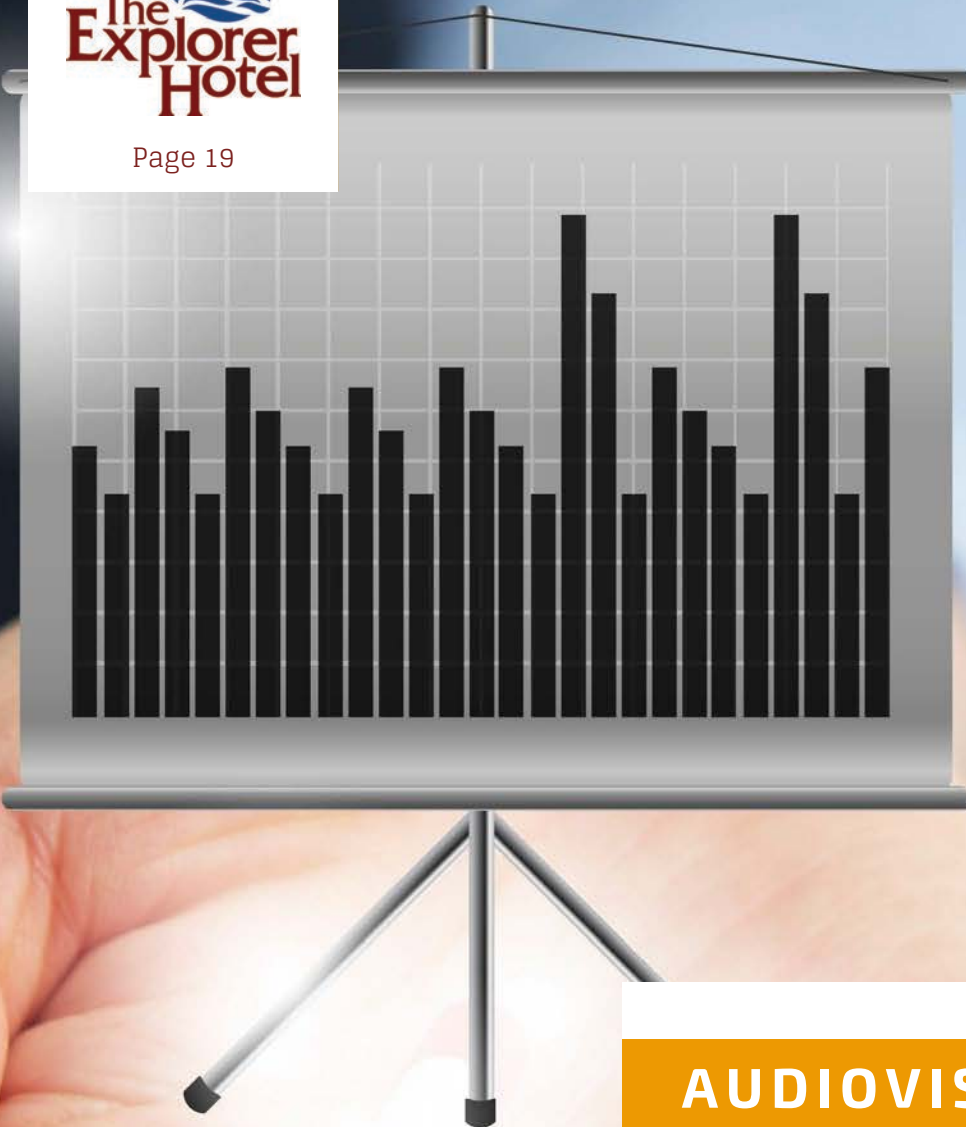

AUDIOVISUAL SERVICES

Complimentary Conference Items

- Conference Service Specialist
- Podium(s)
- Wireless Internet
- Pens and Notepads
- Markers
- Extension Cords
- VGA Cords
- HDMI Cords
- Built-in Screens and Sound Systems



EQUIPMENT RENTAL

Equipment	Daily Rate (From)
LCD Projector	\$150.00
SMART Board	\$95.00
Flat Screen Television	\$50.00
Flipcharts	\$15.00
Extra Flipchart Pads	\$5.00
Wireless Microphone	\$50.00
Lapel Microphone	\$60.00
Conference Phone System	\$125.000



PARTNERSHIPS



The Explorer Hotel has several different partners to help you make your conference, meeting or event a huge success. We work with NWT Conference Bureau, Northwest Territories Tourism and several other local tour operators in planning group adventures and special activities. We will help make your conference as spectacular and memorable as the land and people of the North!







The Conference, Event and Meeting Team

Say hello to our team of experts!



Director, Sales and Marketing
Conference and Banquet Manager
Events Coordinator
Front Office Manager (Rooms)

Kelly Martin | 780.784.4885 | kelly@nunastar.com
Rolland Eric Rakotomena | 867.873.3531 Ext. 7129 | catering@explorerhotel.ca
Macayla Day | 867.873.3531 Ext. 7136 | events@explorerhotel.ca
Diana Sng | 867.783.3531 Ext. 7115 | fom@explorerhotel.ca



The Explorer Hotel

4825 - 49 Avenue

Yellowknife, NT

X1A 2R3

867.873.3531

800.661.0892

Fax 867.873.2789